

THIS DRAWING IS UNPUBLISHED. RELEASED FOR PUBLICATION, 19 .  
 © COPYRIGHT 19 BY AMP INCORPORATED. ALL INTERNATIONAL RIGHTS RESERVED.

LOC	DIST	P	F	REVISIONS				
				ZONE	LTR	DESCRIPTION	DATE	APPD
DF	MO				AD	REV PER 0H14-0005-04 CT	11-04	DM

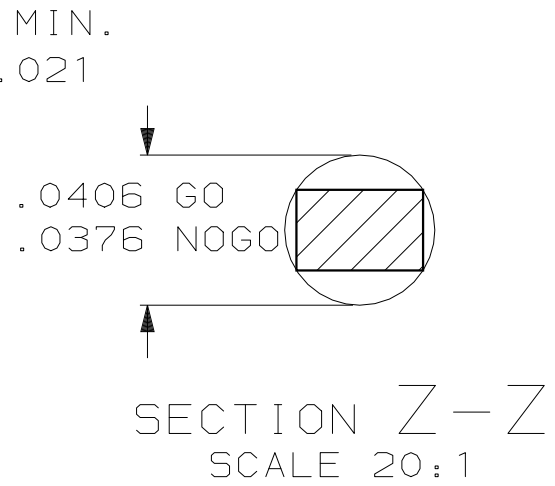
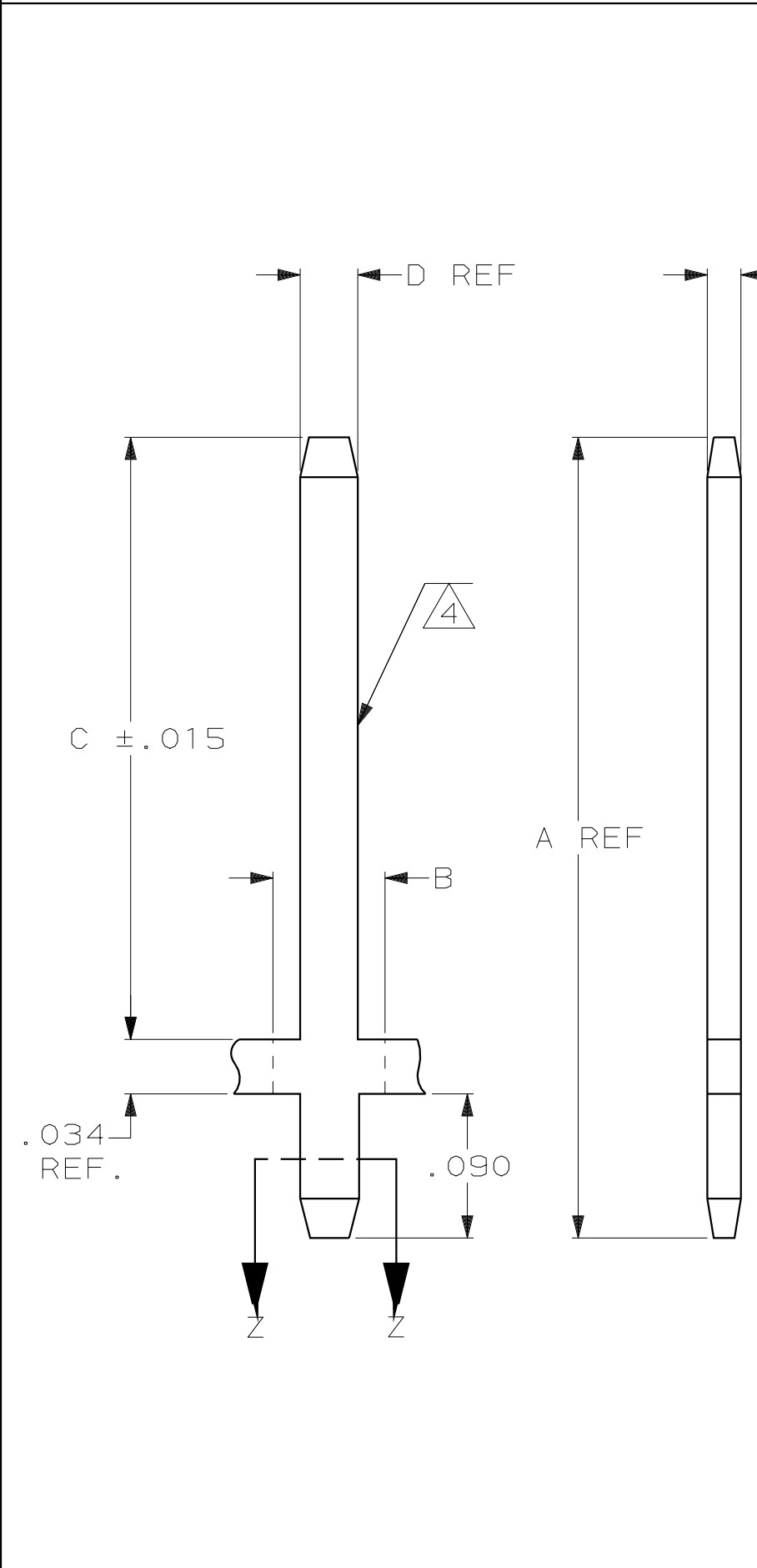

- RECOMMENDED HOLE DIA FOR 1/16 THK. GLASS EPOXY IS .035±.001.
- USABLE POST LENGTH TO BE .500.
- USABLE POST LENGTH TO BE .350.
- DIAGONAL DIM. .0315/.0345 (WRAP TYPE ONLY)
- MATERIAL: BRASS (MIL-C-50)
- GOLD PL. (MIL-G-45204) TYPE II .000030 MIN. THK. OVER NICKEL PL. (QQ-N-290) .000050 MIN. THK
- GOLD PL. (MIL-G-45204) TYPE II .000001 MIN. THK. OVER NICKEL PL. (QQ-N-290) .000050 MIN. THK
- PARTS ON REEL HAVE A  $\phi$  TO  $\phi$  SPACING OF .125.

OBS		D	C	B	A	QTY.	FINISH	MATERIAL	PART NO.
OBS		.027	.318	.070	.442	1			1-67114-5
OBS		.027	.318	STRIP	.442	50M±5M / REEL			1-67114-4
OBS		.036	.276	.070	.400	1			1-67114-2
OBS		.036	.276	STRIP	.400	50M±5M / REEL			1-67114-0
OBS		.036	.376	STRIP	.500	50M±5M / REEL			67114-9
OBS		.036	.376	.070	.500	1			67114-8
OBS		.036	.376	STRIP	.500	50M±5M / REEL			67114-7
OBS		.036	.526	STRIP	.650	50M±5M / REEL			67114-6
OBS		.036	.376	.070	.500	1			67114-5
OBS		.036	.526	.070	.650	1			67114-4

DO NOT SCALE PRINT. UNLESS SPECIFIED DIMENSIONS IN INCHES TOLERANCES ON: 2 PLC DEC ± - 3 PLC DEC ± .008 ANGLES ± 5°	DR 9-11-89 T.WIEST CHK 9-11-89 G.SHAFER APPD 9-11-89 G.SHAFER RLSE 9-11-89 T.WIEST PRODUCT SPEC - APPLICATION SPEC - WEIGHT -	<p><b>AMP</b> AMP INCORPORATED Harrisburg, Pa. 17105</p> <p>NAME POST, FEED TO, TERMI-POINT, WIRE WRAP</p> <p>SIZE <b>B</b> CAGE CODE 00779 DRAWING NO 67114 SCALE 10:1 SHEET 1 OF 1</p>
MATERIAL SEE TABLE		
FINISH SEE TABLE		